

2nd September 2020

Dear Fairfield Families,

Updated information for staggered start and end of school day

Thank you all for your support with the staggered start this morning. It has been wonderful to welcome all the children back to school.

We aim to do our very best to support our practices, and as a result will keep reviewing and improving our systems and procedures.

To ensure that social distancing measures are adhered to please see the following amendments:

- **One adult per family** – where possible
- Please stick to your allocated year group time slot, if you do not have siblings in other year groups. **Please do not arrive earlier than the time slots specified below.**
- Adults to stay on the yellow markers (dots) - these are 2m apart. **Please adhere to social distancing expectations both within the school grounds and beyond.**
- Children will be welcomed into the classrooms by staff. **Please do not take your children to the classroom doors.** Once your child has been welcomed by a member of staff, **please leave the school grounds promptly.**
- To support **Y4,5,6 parents** who wish to bring their children to the main playground:
 - The main schools gates will be open and to avoid queues on Toton Lane footpaths, please **proceed down towards the new pathway gate near the outer fence**, where a member of staff will welcome you
 - Please **follow and remain on the 2m distanced yellow markers**
 - Children will independently walk to their school entrance in the morning.
 - At the end of the day, children will independently walk to you from their class line on the playground.
 - Please note that the **route into the main playground has changed from the previous plan to support with social distancing.**
 - **Gibbons Avenue will be an entry point only** to support with social distancing.

Staggered start and finish time slots are in place to help keep year group bubbles apart when arriving and leaving school. There is a 15 minute time slot to arrive to avoid congestion.

8:30am & 3:00pm – Y3 & Y4

8:45am & 3:15pm – Y1/2/5

9am & 3:30pm – EYFS & Y6

If you are collecting / have children in several year groups please bring/collect them all at the earliest time from their individual class locations identified on the map. If you arrange for your child to be collected by another person, please ensure that the school office is informed.

Please note that the **points of entry from Queen Elizabeth Park at the start and end of the school day will swap.** This is to enable children in Y4, Y5 and Y6 who are walking home unaccompanied, to be able to walk a route avoiding the need to cross the Queen Elizabeth Car Park.

Please follow the one-way systems around school, where possible.

Children in Y4, Y5 and Y6, with written parental permission, will be allowed to leave the school site unaccompanied.

Users of pushchairs/wheelchairs will be able to use routes that avoid steps (please be mindful this may take slightly longer).

If you require any assistance, please do not hesitate to get in touch.

Morning Routes into School

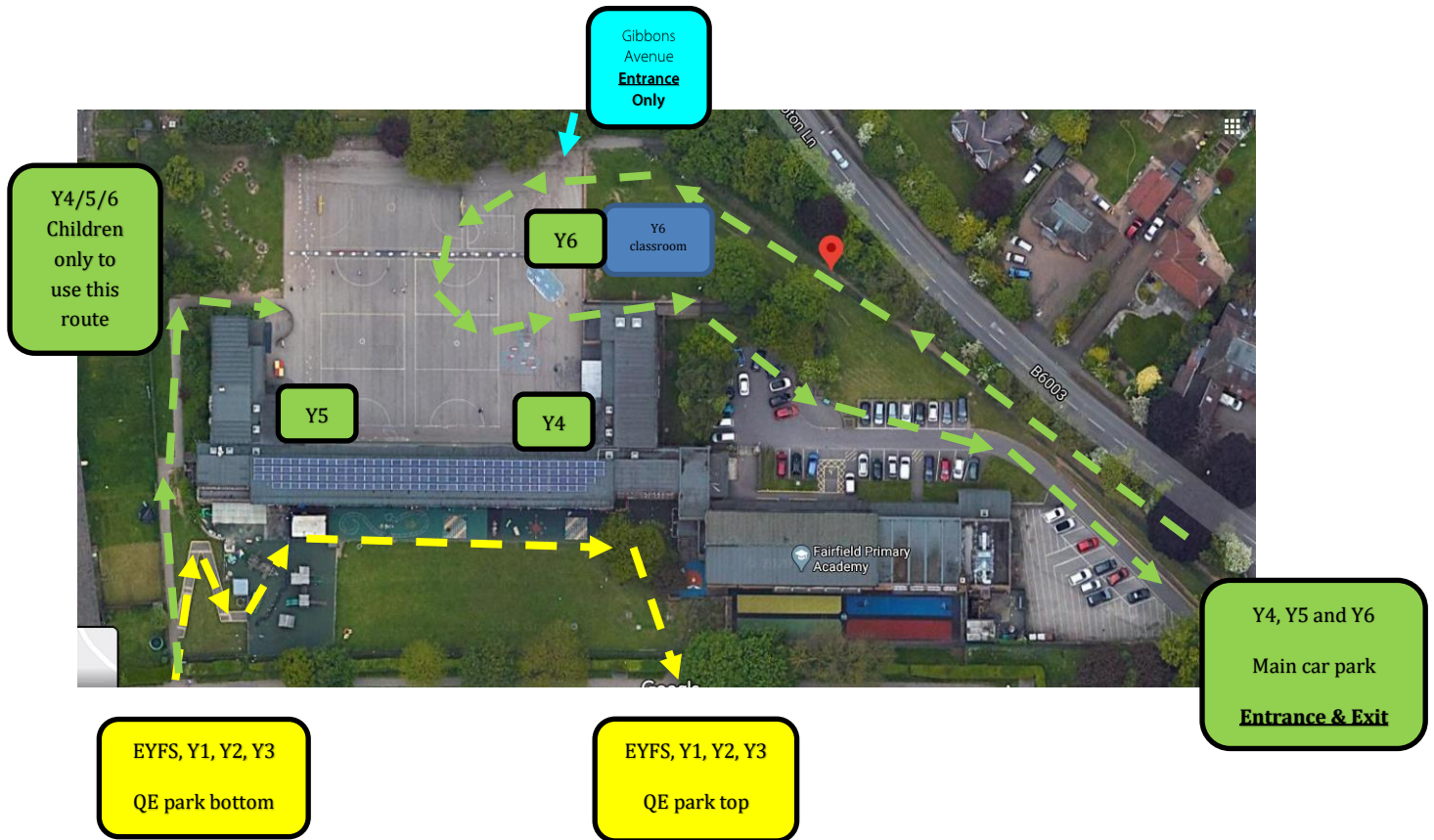

Afternoon Routes out of School

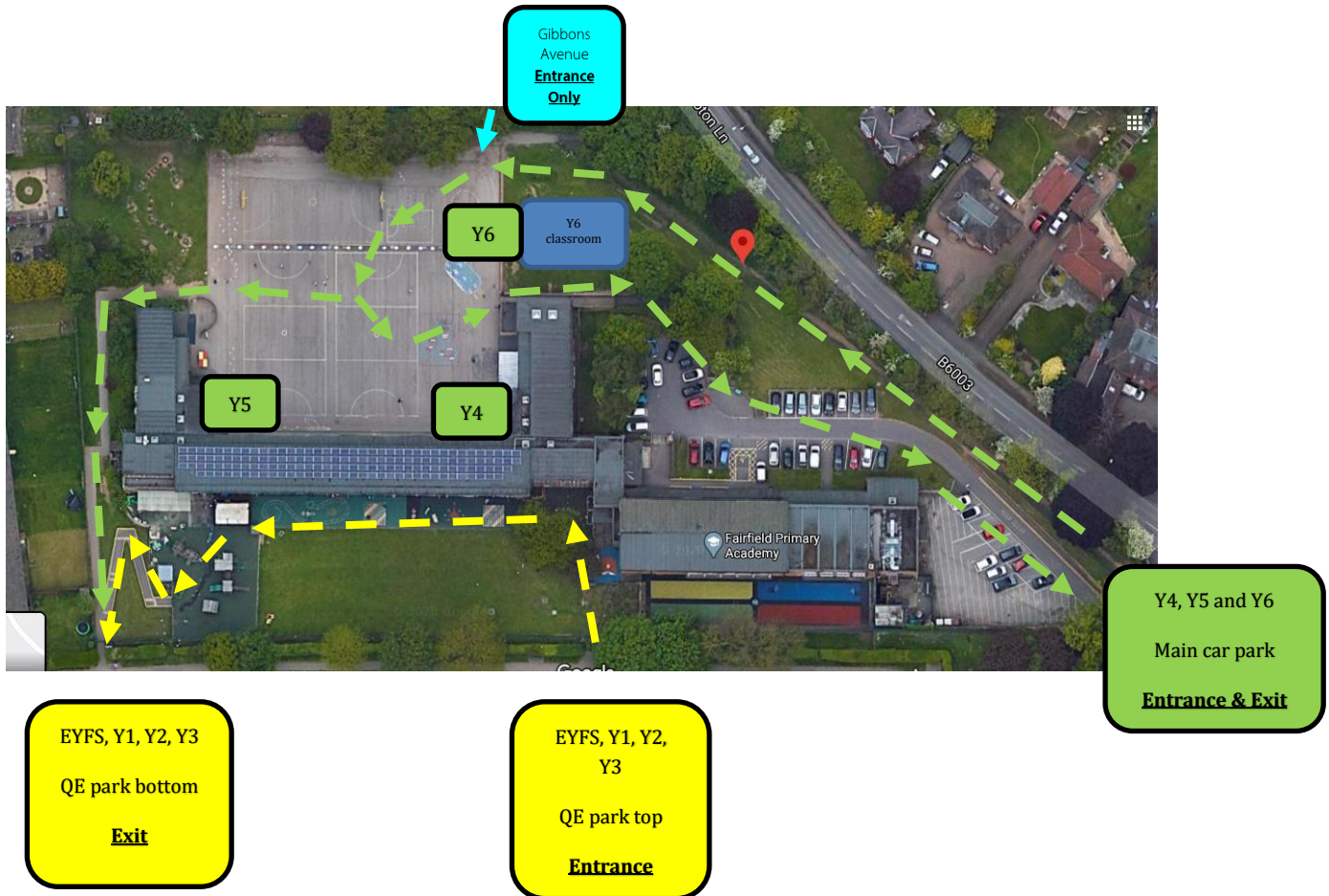

Thank you for your patience and understanding as we work together to improve our procedures. Your child's safety and wellbeing is at the forefront of everything we do.

Kind regards,

Shamara Sadler

Principal